



# Wood Lake Meeting Center

info@woodlakemeetingcenter.com

OFFICE: 507-281-6699 | 210 Wood Lake Drive SE  
FAX: 507-288-7663 | Rochester, MN 55904

# Facility Layout

Oak, Birch, Maple, and Willow wall dividers open/close at dotted lines.

Classroom: 2 per table (can add 1 per 2 tables)

Rounds: 6 per table (can seat 7)

Oak/Birch/Maple/Willow

Classroom: 180

Rounds: 180

Birch/Maple or Maple/Willow

Classroom: 72

Rounds: 72

U Shape: 30

Square: 40

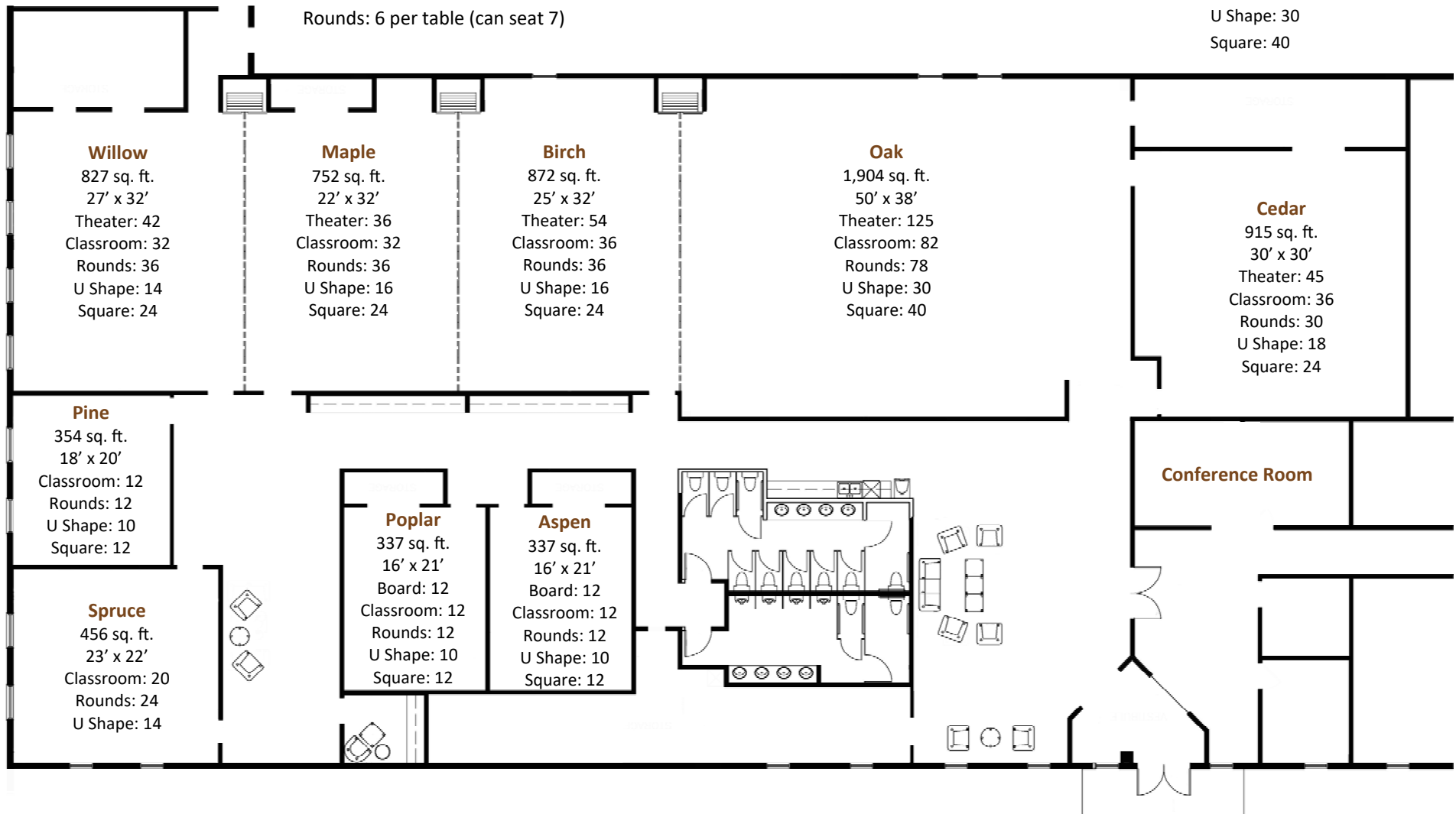



# Wood Lake Meeting Center

info@woodlakemeetingcenter.com

OFFICE: 507-281-6699 | 210 Wood Lake Drive SE  
FAX: 507-288-7663 | Rochester, MN 55904

# Meeting Rooms

**Entrance**



**Quiet Room**



**Spruce**



**Cedar**



**Aspen**



**Poplar**



**Pine**



**Oak**



**Birch**



**Maple**



**Willow**

